

Example used was installed by a competitor on a gas line and on city property!

Locate Sample 2 - ☐ North Service Rd

Submitted to OneCall November 19. Ticket # received same day. As indicated in the first 3 pages of the email

In the case provided there are 10 items to be located by 4 different OneCall members. 2 of the items have been cleared immediately at the time of receiving the ticket, noted by -C

8 Items require a site visit by designated OneCall members (pages4-9):

Locate requested Nov 19 - Completed Nov 26 (5 business days)

Station Code	OneCall Member	Date Completed	
HLTNW01	Region Of Halton	Nov-19	-C
HLTNW02	PVS Halton Region	Nov-19	-C
CBT1	Bethlehem For Cogeco	Nov-23	← First Locate Completed
ROGHN01	PVS Rogers	Nov-24	
BCHN01	PVS Bell	Nov-26	
HLTNWW01	PVS Region Of Halton	Nov-26	
OAKSS01	PVS For Oakville S	Nov-26	
OAKHYD01	PVS For Oakville Hyd	Nov-26	← Last locate completed
UGHN01	PVS For Union Gas	Nov-26	←
UGUCLHAL	Union Gas Critical L	Meet On Site	← Required to meet Union gas on site when installing due to critical gas line in close proximity

**Locate meets OneCall service standard of 5 days
2% of locates**

Karen Kay

From: solutions@on1call.com
Sent: November-19-15 1:37 PM
To: locates@c
Subject: Request 20154711839

ONTARIO ONE CALL Locate Request Confirmation

Ticket #:20154711839 Reason Code:STANDARD
Work to Begin Date: 11/26/2015 Time: 08:00:00 AM
WAP No: 561165

CALLER INFORMATION

KAREN Tel.:(905)839-
Contractor ID: 9360
CORPORATE SIGNS INC Cell:
WORK BEING DONE FOR: Fax:(905)420-
locates@corporatesigns.ca
ALT CONTACT:CHRIS/STEVE/TYLER Tel.:(905)839-

DIG LOCATION

City: OAKVILLE, HALTON
Community:
Address : To: Lot/Unit#:
Street : NORTH SERVICE RD E
Nearest Intersecting Street :
INVICTA DR
Second Intersecting Street :
JOSHUAS CREEK DR
Nb of Segments: 1

Type of Work: SIGN Max Depth: 5.00 FT
Machine Dig: X Hand Dig:
Public Property: Private Property: X
Mark & Fax: X Site Meet Req.: Area is Not Marked: X
Area is Marked:
Directional Drilling:

Work Extent/Location:
CORLOT=1 FROM 2M NORTH OF NFC TO PARKING AND FROM

2M EAST EFC 25M EAST - FRONT

Remarks:

The Ontario One Call members who have underground infrastructure in the area of your excavation site have been notified and their status is noted below:

BCHN01 PVS FOR BELL CANADA CBT1 BETHLEHEM FOR COGECO
HLTNW01 -C REGION OF HALTON - W HLTNW02 -C PVS FOR HALTON REGIO
HLTNWW01 PVS FOR HALTON REGIO OAKHYD01 PVS FOR OAKVILLE HYD
OAKSS01 PVS FOR OAKVILLE STO ROGHN01 PVS FOR ROGERS (ROGH
UGCLHAL UNION GAS CRITICAL L UGHN01 PVS FOR UNION GAS (U

These members have been removed due to the relocate:

Note: -C = Cleared, -S = Supressed, -L = Lookup center cleared, -A = Alternate Locate,
-R = Existing locate valid - maintain marks

IMPORTANT INFORMATION:

DEFINING 'NC' - NON-COMPLIANT

- Non-compliant members have not met their obligations under section 5 of the Ontario Underground Infrastructure Notification Act. ON1Call has notified these members to ensure they are aware of your excavation. In this circumstance, should the member not respond, the excavator should contact the member directly to obtain their locates or request a status. ON1Call will not be provided with a locate status from the member regarding this ticket and therefore, cannot provide further information at this time. For locate status contact information please refer to our website.

YOU HAVE A VALID LOCATE WHEN...

- You have reviewed your locate request information for accuracy. CONTACT Ontario One Call (ON1Call) IMMEDIATELY if changes are needed and obtain a corrected locate request confirmation.
- You have obtained locates or clearances from all ON1Call members listed in this ticket before beginning your dig.

YOU'VE MET YOUR OBLIGATIONS WHEN...

- In addition to this locate request, you have DIRECTLY contacted all owners of infrastructure who ARE NOT current members of ON1Call (such as owned buried infrastructure on private property), as well as arranged for contract locates for your private lines on your private property - where applicable. For a list of locate status contacts visit www.on1call.com.

- You respect the marks and instructions provided by the locators and dig with care; the marks and locator instructions **MUST MATCH**.
- You have obtained any necessary permits from the municipality in which you are excavating.

WHAT DOES (-C) MEAN?

1. The information that you have provided about your dig will not affect that member's underground infrastructure OR,
2. The member has identified that they do not have buried infrastructure in the immediate area and wish to inform the excavator by providing a (-C).

IF THE (-C) IS NOT PRESENT:

- Not all members of ON1Call identify the absence of infrastructure in their registration with ON1Call, in which case the member's name will not appear on your request confirmation. The absence of (-C) indicates the ON1Call system has returned no results for the presence of a particular member's infrastructure in the immediate vicinity. See www.on1call.com for a current list of locate status contacts.

Bethlehem Locates

From: solutions@on1call.com
Sent: Thursday, November 19, 2015 1:37 PM
To: Bethlehem Locates
Subject: Request 20154711839
Attachments: 20154711839.PNG; 20154711839_1.PNG

1

ONTARIO ONE CALL

NOTICE OF INTENT TO EXCAVATE Header Code:STANDARD

Ticket No: 20154711839 Seq. No: 48

Update of:

Send To: CBT1 Seq No: 0048 Map Ref: 905 849

Original Call Date: 11/19/2015 Time: 01:36:26 PM OP: 59

Transmit Date: 11/19/2015 Time: 01:36:26 PM

Work to Begin Date: 11/26/2015 Time: 08:00:00 AM

Company: CORPORATE SIGNS INC

Contact Name: KAREN Contact Phone: (905)839-

Alternate Contact: CHRIS/STEVE/TYLER Altern. Phone: (905)839-

Best Time to Call: ANYTIME Fax No: (905)420

Cell Phone: Pager No:

Caller Address: 1 ORANGEBROOK CRT

PICKERING, ON L1W 3G8

Email Address: locates@corporatesigns.ca

Reg/County: HALTON City: OAKVILLE

Address: NORTH SERVICE RD E

Lot/Unit#:

To Address:

Nearest Intersecting Street: INVICTA DR

2nd Intersecting Street: JOSHUAS CREEK DR

Community:

Nb of Segments: 1

WAP No: 561165

Latitude: 43.47506425 Longitude: -79.67589950

Work Extent/Locn: CORLOT=1 FROM 2M NORTH OF NFC TO PARKING AND FROM
2M EAST EFC 25M EAST - FRONT

Remarks:

Type of Work: SIGN

Depth: 5.00 FT

Cleared by Bethlehem Trenching
for COGECO CABLE
On Private Property Only
20154711839-48
valid 60 days

← Rogers

ROGERS

ROGERS LOCATE SERVICE

CLEAR TO DIG

8200 Dixie Rd
East Bldg, 2nd Flr
Brampton, Ontario, L6T 0C1
Tel.: (855) 232-0342
Fax.: (905) 780-7379

TICKET#: 20154711839
CLEARANCE#: A2371129
DATE: 11/24/15 10:43:14 AM

ROGHN01

Requested By: Company: CORPORATE SIGNS INC

Contact name: KAREN KAY Ph: (905)-839 Fax: (905)-420

Dig Site Location :

Municipality : OAKVILLE

Call Date: 11/19/15 1:36:00 PM

Address : NORTH SERVICE RD E Intersection : INVICTA DR

Remarks (Additional Dig Info)

CORLOT=1 FROM 2M NORTH OF NFC TO PARKING AND FROM 2M EAST EFC 25M EAST -
FRONT

ROGHN01 PVS FOR ROGERS (ROGH
U_CROQUIS1:20154711839_1.PNG
U_CROQUIS2:20154711839.PNG

ALL CLEAR HAS BEEN GIVEN FOR THE WORK AREA DESCRIBED ABOVE.

YOU WILL BE LIABLE FOR ANY DAMAGES TO ROGERS FACILITIES IF EXCAVATING / DIGGING PRIOR
TO RECEIVING A COMPLETED LOCATE OR CLEARANCE NUMBER FROM ROGERS OR IT'S AGENTS.

PLEASE CALL ROGERS LOCATE SERVICES AT (800) 738-7893, IF THERE ARE ANY CHANGES TO THIS
LOCATE REQUEST. LOCATES AND CLEARANCES ARE VALID FOR 60 DAYS ONLY.

CAUTION: Stakes and or markings may disappear or be displaced. Should the sketches and
markings not coincide, a new stake out must be obtained.

**FOR ALL CUT CABLES CALL
1-800-265-9501**

 Standard		Primary Locate Sheet Line Location Request				Page 1 of 4 20154711839-976702			
		Phone: 905-984-5197 Fax: 905-984-5367 Toll Free: 877-558-5569							
Locating for: Bell Canada, Oakville Hydro, Town of Oakville Storm Sewers, Union Gas ALA Critical, Union Gas, Halton				Revised Excavation Date: 26-Nov-15		Excavation Date: 26-Nov-15		Status: LOCATE COMPLETED	
Requested by: KAREN KAY		Company: CORPORATE SIGNS INC		Phone:		Fax:		Request Type: CONTRACTOR	
Appt. Date:		Received Date: 20-Nov-15		Type of Work: SIGN					
Locate Address: NORTH SERVICE RD E: OAKVILLE						Excavator City: 3-1734 ORANGEBROOK, PICKERING			
Caller's Remarks: CORLOT=1 FROM 2M NORTH OF NFC TO PARKING AND FROM 2M EAST EFC 25M EAST - FRONT 905 849-L6H									
Gas N/A-1 M-1		Bell M-1		CATV		Hydro FC-1		Water FC-1 FC-1	
						Sewer		Street Lighting	
								Fibre	
LOCATED AREA: EXCAVATOR SHALL NOT WORK OUTSIDE THE LOCATED AREA WITHOUT OBTAINING ANOTHER LOCATE									
DPT Remarks: HALTON REGION WASTE WATER CLEAR ON PRIVATE PROPERTY AND CLEAR OF TOWN OF OAKVILLE STORM SEWERS IN LOCATED AREA				<input type="checkbox"/> Third Party Notification _____					
				<div style="border: 1px solid black; padding: 10px; background-color: #ffffcc;"> <p style="text-align: center; margin: 0;">Notice</p> <p style="text-align: center; margin: 5px 0;">A UNION GAS REPRESENTATIVE MUST BE PRESENT DURING ANY ACTIVITY WITHIN 1.5 METRES FROM PLANT AT THIS LOCATION. A CROSSING AGREEMENT MAY BE NECESSARY. PLEASE CALL 1-855-228-4909 3 BUSINESS DAYS NOTICE REQUIRED</p> <p style="text-align: center; margin: 0;"><small>uniongas</small></p> </div>					
Record Reference <input type="checkbox"/> Utility Map <input checked="" type="checkbox"/> Multiviewer Datapak #: _____									
Atlas Plates:									
Field Notes:									
Diameter of Main: 8				Material Type: Gas <input type="checkbox"/> Cast iron <input type="checkbox"/> Steel <input type="checkbox"/> Plastic Telephone <input checked="" type="checkbox"/> Cable <input checked="" type="checkbox"/> Conduit <input checked="" type="checkbox"/> Telephone Fibre CATV <input type="checkbox"/> TV Fibre Hydro <input type="checkbox"/> Primary <input type="checkbox"/> Direct Buried <input type="checkbox"/> Secondary <input type="checkbox"/> Duct <input type="checkbox"/> Street Lighting Water <input type="checkbox"/> Locate is Approximate Due To Non-metallic Pipe					
Excavator shall notify and receive a clearance from Regional Contacts prior to excavation for the following: Gas <input type="checkbox"/> End Thrust <input type="checkbox"/> Vital Main <input type="checkbox"/> Valve Telephone <input type="checkbox"/> High Priority Cables <input type="checkbox"/> Central Office Vicinity									
Method of Field Marking: <input checked="" type="checkbox"/> Paint <input type="checkbox"/> Stakes <input type="checkbox"/> Flags <input type="checkbox"/> Offset Stakes <input type="checkbox"/> Chalk <input type="checkbox"/> Steel									
Caution: Locate is VOID after 30 days; Bell has exceptions, see attached letter. Cogeco locate valid for 60 days and Region of Halton valid for 60 days. For all locate requests including remarks contact Ontario One Call 1-800-400-2255.									
Caution: The markings may disappear or be misplaced. Should sketch markings not coincide, a new locate must be obtained. This is based on information given at the time. Any changes to location or nature of work requires a new locate. The EXCAVATOR must not work outside the indicated Located Area without a further locate by the company. Privately owned facilities may be present in the Locate Area,									
Documents given to be used with this locate: <input checked="" type="checkbox"/> None <input type="checkbox"/> NEB Excavation/Construction Booklet <input type="checkbox"/> Gas Excavation Guidelines <input type="checkbox"/> Hydro Electric Excavation Guidelines <input type="checkbox"/> Bell Guidelines for Excavation				ID Number: 397 Dat L. Date/Time: 26-Nov-2015 1:09 pm In/Out: 1:08 pm 1:08 pm		Accepted by: _____ Print: _____ <input checked="" type="checkbox"/> Mark and Fax / Email <input type="checkbox"/> Left on Site			
A copy of this Primary Locate Report and the Auxiliary Locate Sheet(s) must be on site and in the hands of the machine operator during work operations. Should sketch and markings not coincide, a new locate must be obtained.									

Auxiliary Locate Sheet		Page 2 of 4
Line Location Request		
Locating Union Gas	Request #: 20154711839-976702	Requested By: CORPORATE SIGNS INC
Number of Addresses: (Specify Building Numbers):		
LOCATED AREA: EXCAVATOR SHALL NOT WORK OUTSIDE THE LOCATED AREA WITHOUT OBTAINING ANOTHER LOCATE		
From: 4MN OF N.RE OF NORTH SERVICE RD E	To: S EDGE PARKING LOT OF 1135	
From: 2ME OF TV BIG PED	To: 5ME OF POLE # 7857	
<p>This form valid only with the primary locate form.</p> <p>LEGEND:</p> <p>Limit of Locate -- LCL --</p> <p>Building Line -- BL --</p> <p>Property Line -- PL --</p> <p>Fence Line -- FL --</p> <p>Center Line -- CL --</p> <p>Curb -- CL --</p> <p>Road Edge -- RE --</p> <p>Pavement edge of asphalt or road surface.</p> <p>Drive Way: -- DW --</p> <p>Manhole: MMH</p> <p>Catch Basin: CB</p> <p>Sidewalk: SW</p> <p>Pole: </p> <p>Railway: </p> <p>Pedestal: </p> <p>Telephone Cable: -- B --</p> <p>Conduit: -- C --</p> <p>Buried Service Wire: -- BSW --</p> <p>Gas Main: -- GM --</p> <p>Gas Service: -- GS --</p> <p>Gas Valve: </p> <p>Hydrant: </p> <p>Transformer: </p> <p>Hydro: -- H --</p> <p>Hydro Service: -- HS --</p> <p>Street Light Cable: -- SL --</p> <p>CATV: -- TV --</p> <p>Limit of utility owned facilities: DUT</p> <p>Fibre Optics: -- FO --</p>	<p style="text-align: center;">HAND DIG WITHIN 1M (3.28ft) AS MEASURED HORIZONTALLY FROM THE FIELD MARKINGS DEPTH VARIES AND MUST BE VERIFIED BY HAND DIGGING <input type="checkbox"/> LOCATED AREA HAS BEEN ALTERED AS PER:</p> <div style="border: 1px solid black; padding: 10px; margin: 10px 0;"> <p style="text-align: center;">Notice</p> <p style="text-align: center;">A UNION GAS REPRESENTATIVE MUST BE PRESENT DURING ANY ACTIVITY WITHIN 1.5 METRES FROM PLANT AT THIS LOCATION. A CROSSING AGREEMENT MAY BE NECESSARY. PLEASE CALL 1-855-228-4909 3 BUSINESS DAYS NOTICE REQUIRED</p> <p style="text-align: center;"> uniongas</p> </div>	
<p>Any Privately owned services within limits of this locate have not been marked - check with service/property owner.</p>		

A copy of this Auxiliary Locate Sheet and the Primary Locate Report must be on site and in the hands of the machine operator during work operations.



Auxiliary Locate Sheet

Page 3 of 4

Line Location Request

Phone: 905-984-5197

Toll Free: 877-558-5569

Fax: 905-984-5367

Locating **Bell Canada**
For:Request #:
20154711839-976702Requested By:
CORPORATE SIGNS INC

Number of Addresses: (Specify Building Numbers):

LOCATED AREA: EXCAVATOR SHALL NOT WORK OUTSIDE THE LOCATED AREA WITHOUT OBTAINING ANOTHER LOCATE

From: 4M N OF N.RE OF NORTH SERVICE RD E





To: S EDGE PARKING LOT OF 1135

From: 2M E OF TV BIG PED

To: 5M E OF POLE # 7857

This form valid
only with the
primary locate
form.

LEGEND:

- Limit of Locate - LCL -
- Building Line - BL -
- Property Line - PL -
- Fence Line - FL -
- Center Line - CL -
- Curb - CL -
- Road Edge - RE -
- Pavement edge of asphalt or road surface.
- Drive Way - DW -
- Manhole  MHT
- Catch Basin  CB
- Sidewalk  SW
- Pole  O
- Railway  HHH
- Pedestal  X
- Telephone Cable - B -
- Conduit - C -
- Buried Service Wire - BSW -
- Gas Main - GM -
- Gas Service - GS -
- Gas Valve  V
- Hydrant  H
- Transformer  T
- Hydro - H -
- Hydro Service - HS -
- Street Light Cable - SL -
- CATV - TV -
- Limit of utility owned facilities  ON
- Fibre Optics - FO -

HAND DIG WITHIN 1M (3.28ft) AS MEASURED HORIZONTALLY FROM THE FIELD MARKINGS
DEPTH VARIES AND MUST BE VERIFIED BY HAND DIGGING
☐ LOCATED AREA HAS BEEN ALTERED AS PER:

Priority Cables Present

All crossings must be exposed by excavator.

Excavator will verify depth before crossing.

Excavator will leave exposed until crossing is complete.

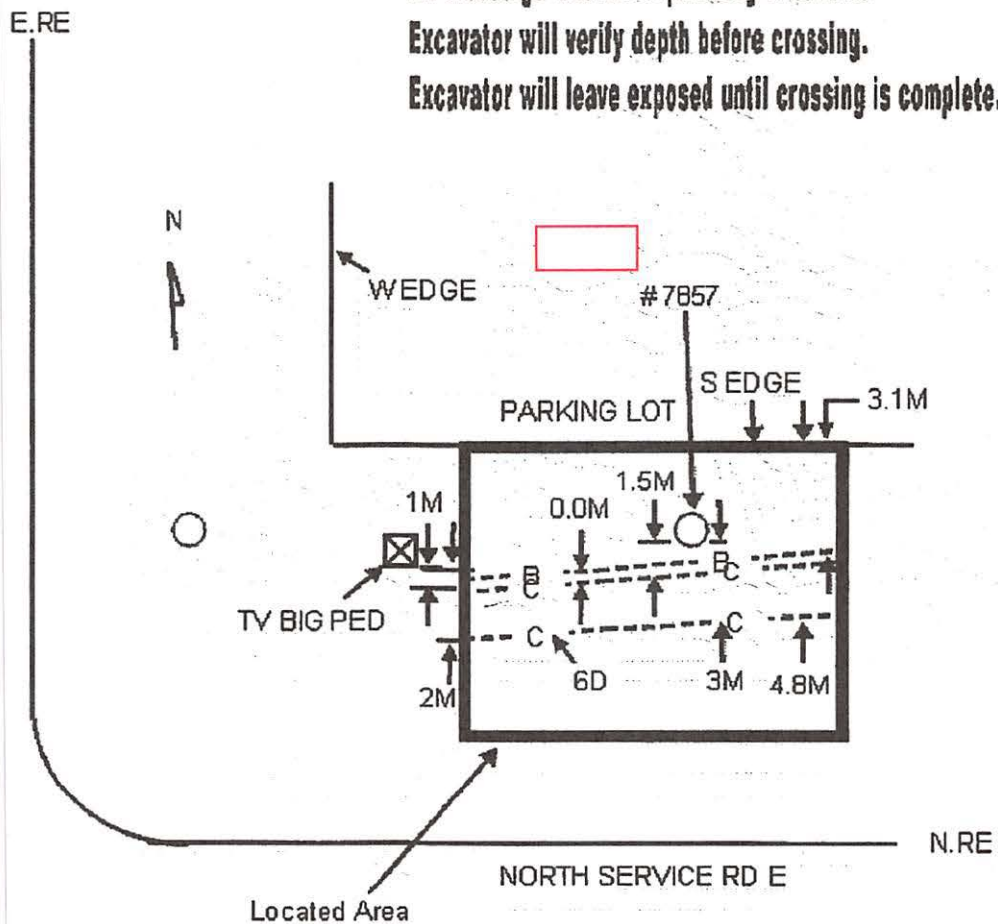

Any Privately owned services within limits of this locate have not been marked - check with service/property owner.

A copy of this Auxiliary Locate Sheet and the Primary Locate Report must be on site and in the hands of the machine operator during work operations.

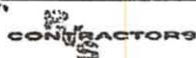

Auxiliary Locate Sheet

Page 4 of 4

Line Location Request

Phone: 905-984-5197

Toll Free: 877-558-5569

Fax: 905-984-5367

Locating **Oakville Hydro,**
For:Request #:
20154711839-976702Requested By:
CORPORATE SIGNS INC

Number of Addresses: (Specify Building Numbers):

LOCATED AREA: EXCAVATOR SHALL NOT WORK OUTSIDE THE LOCATED AREA WITHOUT OBTAINING ANOTHER LOCATE

From: 4M N OF N.RE OF NORTH SERVICE RD E











To: S EDGE PARKING LOT OF

From: 2M E OF TV BIG PED

To: 5M E OF POLE # 7857

This form valid
only with the
primary locate
form.

LEGEND:

- Limit of Locate - LCL -
- Building Line - BL -
- Property Line - PL -
- Fence Line - FL -
- Center Line - CL -
- Curb - CL -
- Road Edge - RE -
- Pavement edge of asphalt or road surface.
- Drive Way: -DW -
- Manhole  MH
- Catch Basin  CB
- Sidewalk  SW
- Pole  P
- Railway  R
- Pedestal  PD
- Telephone Cable - TC -
- Conduit - C -
- Buried Service Wire - BSW -
- Gas Main - GM -
- Gas Service - GS -
- Gas Valve  GV
- Hydrant  H
- Transformer  T
- Hydro  H
- Hydro Service - HS -
- Street Light Cable - SL -
- CATV - TV -
- Limit of utility owned facilities  LUF
- Fibre Optics - FO -

HAND DIG WITHIN 1M (3.28ft) AS MEASURED HORIZONTALLY FROM THE FIELD MARKINGS
DEPTH VARIES AND MUST BE VERIFIED BY HAND DIGGING
☐ LOCATED AREA HAS BEEN ALTERED AS PER:

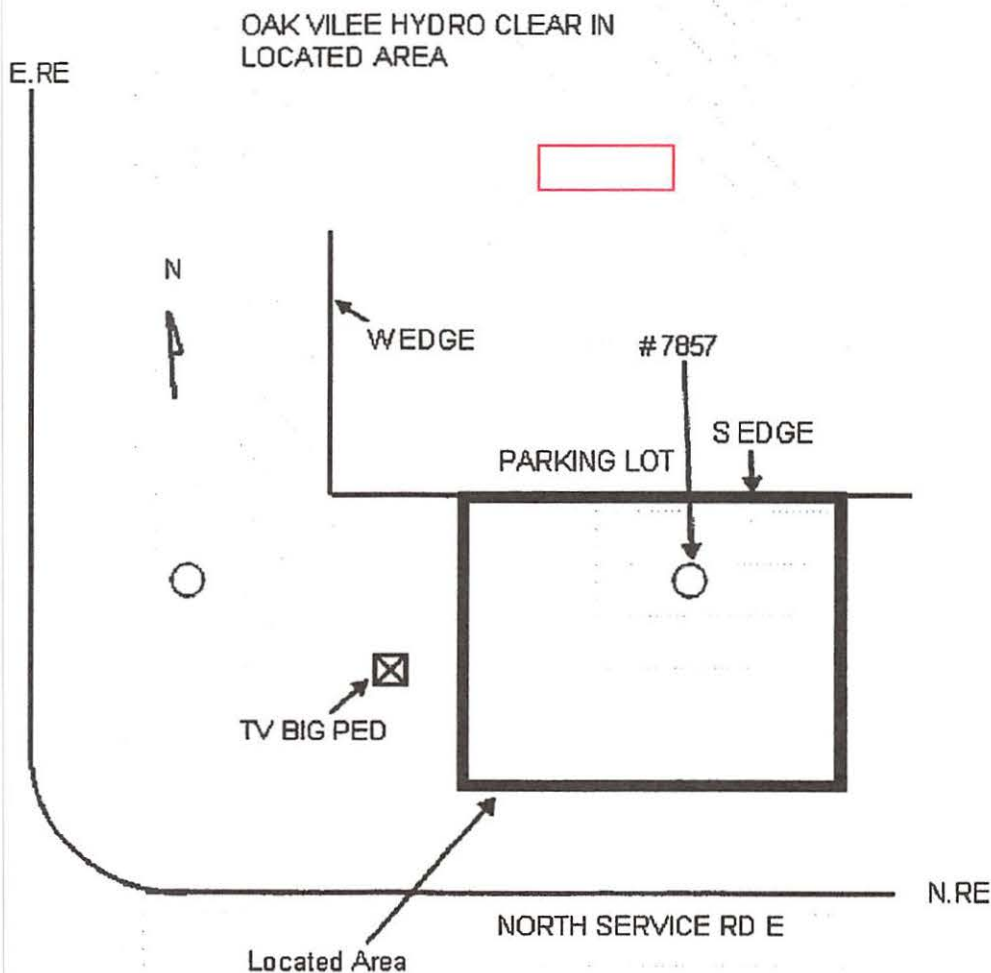

Any Privately owned services within limits of this locate have not been marked - check
with service/property owner.

A copy of this Auxiliary Locate Sheet and the Primary Locate Report must be on site and in the hands of the machine operator during
work operations.

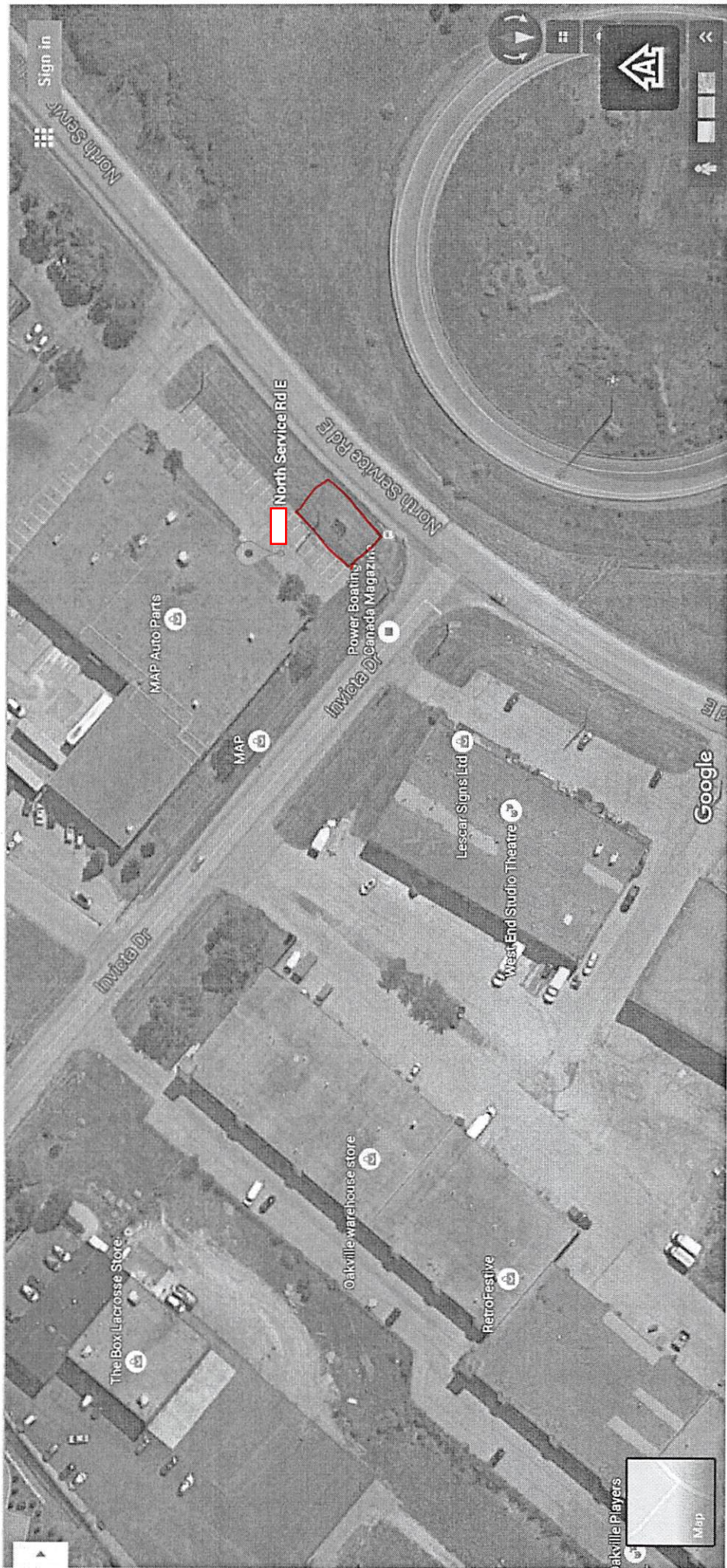

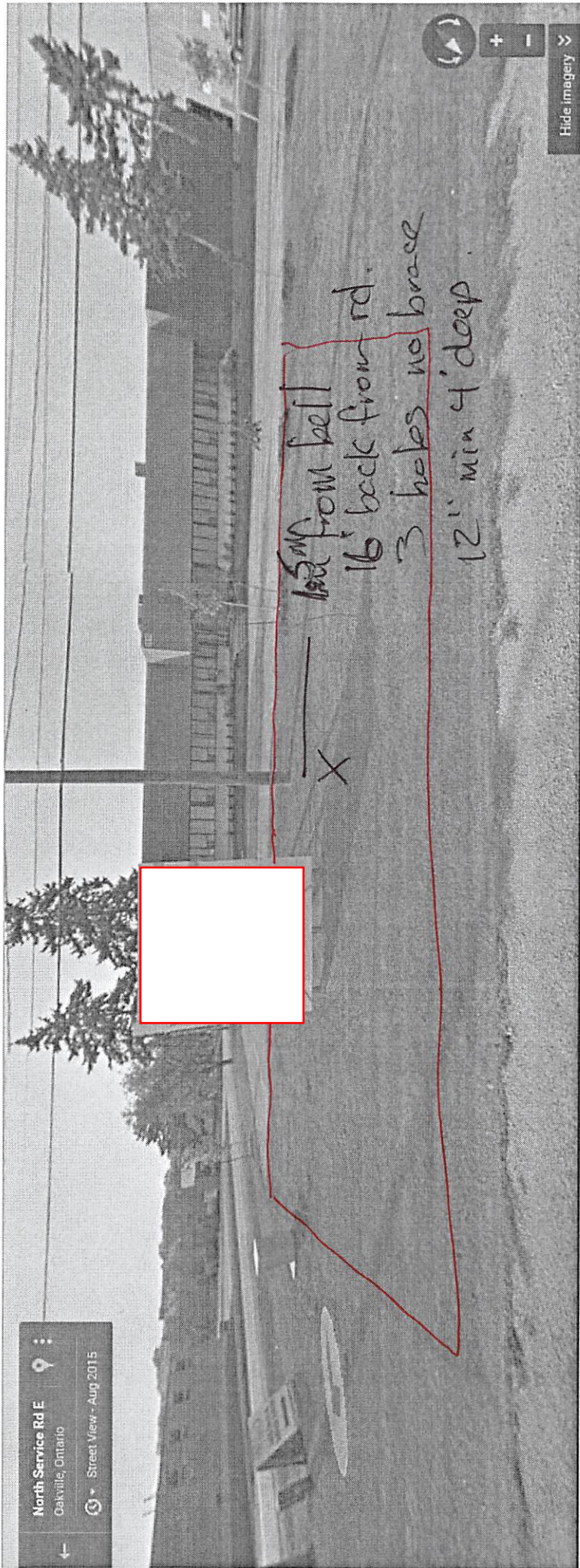

15m from bell
16' back from rd.
3 holes no brace
12" min 4' deep

